

Reconstructions: Architecture and Blackness in America

February 27, 2021-May 31, 2021

The Museum of Modern Art, New York

11W53, On View, 3rd Floor, North Gallery



Manifesting Statement, 2020
Lasercut double layered denim
10 x 10'



J. Yolande Daniels
Dictionary Plate 1 - Race, 2020
Digital File
24 x 18" (61 x 45.7 cm)



J. Yolande Daniels
Dictionary Plate 2 - Calafia, 2020
Digital File
24 x 18" (61 x 45.7 cm)



J. Yolande Daniels
Dictionary Plate 3 - Calle de los Negros, 2020
Digital File
24 x 18" (61 x 45.7 cm)

Reconstructions: Blackness and Architecture in America



J. Yolande Daniels

Dictionary Plate 4 - Mason Block, 2020

Digital File

24 × 18" (61 × 45.7 cm)



J. Yolande Daniels

Dictionary Plate 5 - Brick Block, 2020

Digital File

24 × 18" (61 × 45.7 cm)



J. Yolande Daniels

Dictionary Plates 6 - Azusa, 2020

Digital File

24 × 18" (61 × 45.7 cm)

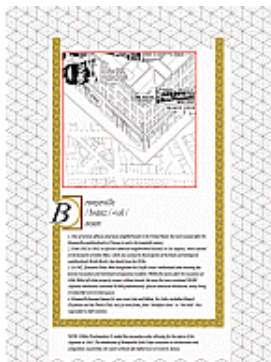

J. Yolande Daniels

Dictionary Plates 7 - Bronzeville, 2020

Digital File

24 × 18" (61 × 45.7 cm)

Reconstructions: Blackness and Architecture in America



J. Yolande Daniels

Dictionary Plate 8 - Dunbar Hotel, 2020

Digital File

24 × 18" (61 × 45.7 cm)



J. Yolande Daniels

Dictionary Plate 9 - Sugar Hill, 2020

Digital File

24 × 18" (61 × 45.7 cm)



J. Yolande Daniels

Dictionary Plate 10 - Bay Beach, 2020

Digital File

24 × 18" (61 × 45.7 cm)

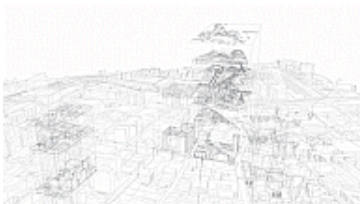

J. Yolande Daniels

Ghost Map 19C, 2020

Digital File

60 × 120" (152.4 × 304.8 cm)

Reconstructions: Blackness and Architecture in America

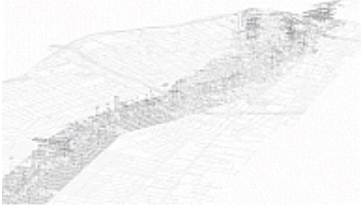

J. Yolande Daniels
Ghost Map 20C, 2020
Digital File
60 × 120" (152.4 × 304.8 cm)



J. Yolande Daniels
Model 1, 2020
High-density polyurethane foam, latex paint, laser-cut and etched cast acrylic, thermoplastic filament 3D prints, maple hardwood, and Baltic birch plywood base
a. 18 x 30 x 32"
b. 18" x 30" x 30"



Felecia Davis
Flower Antenna, 2020
Fiberglass compression rods, fiberglass support ring, aluminum compression rings, cotton thread, copper and polyester yarn, and cotton rope
Dimensions variable

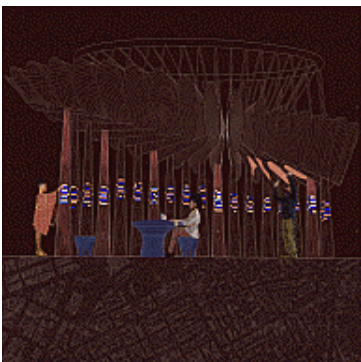

Felecia Davis
Drawing 2, 2020
Digital file
24 × 24" (50.8 × 182.9 cm) x 3

Reconstructions: Blackness and Architecture in America

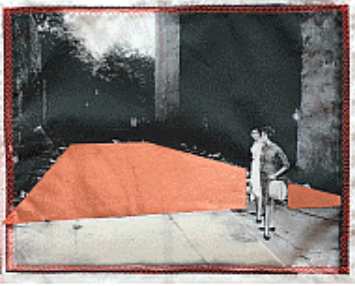

Felecia Davis

Quilt Panel 1, 2020

Cotton muslin, digital print, copper ripstop nylon, and cotton thread
8.75 x 11"



Felecia Davis

Quilt Panel 2,

Cotton muslin, digital print, copper ripstop nylon, and cotton thread
8.75 x 11"



Mario Gooden

Trolley, 2020

Aluminum framed structure; Wood; Fabric; Digital Media
180 x 55 x 118" (457.2 x 139.7 x 299.7 cm)



Kris Graves

Photograph 1, 2020

40 x 30" (101.6 x 76.2 cm)

Reconstructions: Blackness and Architecture in America



Kris Graves

Photograph 2, 2020

40 × 30" (101.6 × 76.2 cm)



Amanda Williams, American, born 1974

spaceboatshipvesselcapsule, 2020

Aluminum frame with mixed media cladding

60 × 60 × 84" (152.4 × 152.4 × 213.4 cm)

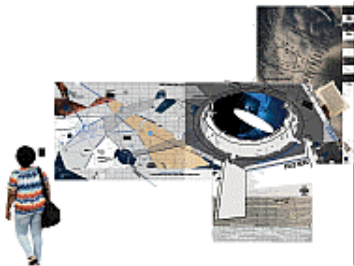

Amanda Williams, American, born 1974

Emergency Blankets, 2020

Screen printing on foil mylar emergency blanket

108 × 252" (274.3 × 640.1 cm)



Amanda Williams, American, born 1974

Video file, 2020

AV file

Reconstructions: Blackness and Architecture in America

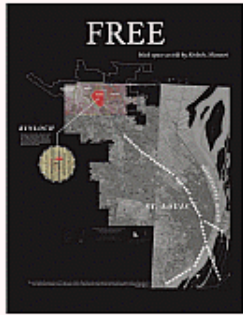

Amanda Williams, American, born 1974
Spatial Diagrams 1, 2020
Ink on paper
20 x 26"



Amanda Williams, American, born 1974
Spatial Diagrams 2, 2020
Ink on paper
20 x 26"

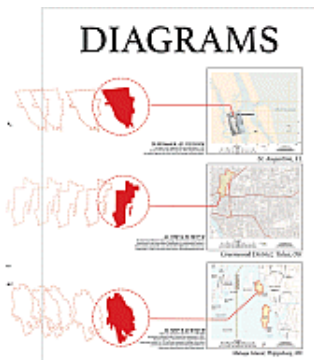

Amanda Williams, American, born 1974
Spatial Diagrams 3, 2020
Ink on paper
20 x 26"



Amanda Williams, American, born 1974
Spatial Diagrams 4, 2020
Ink on paper
26 x 12"

Reconstructions: Blackness and Architecture in America



Amanda Williams, American, born 1974
Spatial Diagrams 5, 2020
Ink on paper
26 x 12"



Amanda Williams, American, born 1974
Spatial Diagrams (framed) 6, 2020
Ink on paper
26 x 12"



Amanda Williams, American, born 1974
Patent to Black Space,
Ink on paper
11 x 51" (27.9 x 129.5 cm)



Amanda Williams, American, born 1974
Letter from USPO,
Ink on paper
11 x 9.5"

Reconstructions: Blackness and Architecture in America

Amanda Williams, American, born 1974

Poem (Audio), 2020

AV file



David Hartt, Canadian, born 1967

On Exactitude in Science (Watts), 2020

AV files

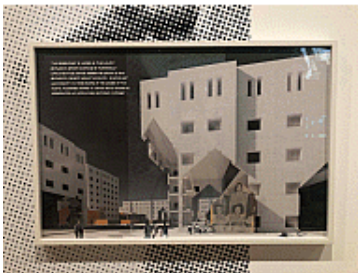

Sekou Cooke

Medium Drawing 1, 2020

pencil, ink, ink-transfer, and digital print on paper

25 x 37 x 1.5"



Sekou Cooke

Medium Drawing 2, 2020

pencil, ink, ink-transfer, and digital print on paper

24 x 36" (61 x 91.4 cm)

Reconstructions: Blackness and Architecture in America

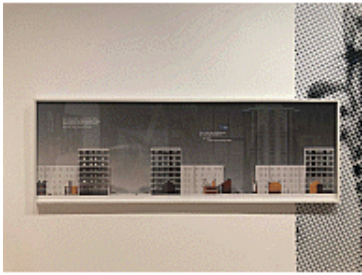

Sekou Cooke

Large Drawing, 2020

pencil, ink, ink-transfer, and digital print on paper

73 x 25 x 1.5"



Sekou Cooke

Small Drawings 1, 2020

pencil, ink, ink-transfer, and digital print on paper

12 x 12" (30.5 x 30.5 cm)

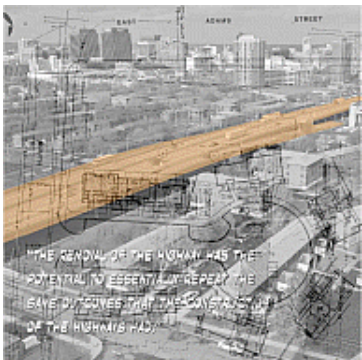

Sekou Cooke

Small Drawings 2, 2020

pencil, ink, ink-transfer, and digital print on paper

12 x 12" (30.5 x 30.5 cm)



Sekou Cooke

Small Drawings 3, 2020

pencil, ink, ink-transfer, and digital print on paper

12 x 12" (30.5 x 30.5 cm)

Reconstructions: Blackness and Architecture in America



Sekou Cooke

Small Drawings 4, 2020

pencil, ink, ink-transfer, and digital print on paper

12 × 12" (30.5 × 30.5 cm)

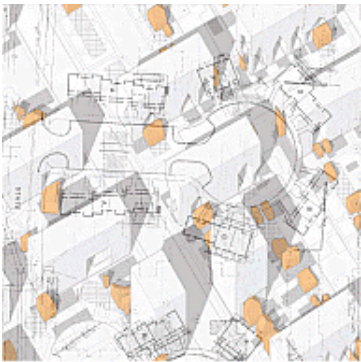

Sekou Cooke

Small Drawings 5, 2020

pencil, ink, ink-transfer, and digital print on paper

12 × 12" (30.5 × 30.5 cm)

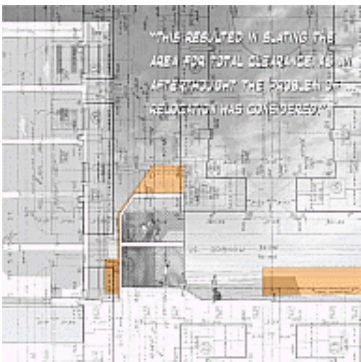

Sekou Cooke

Small Drawings 6, 2020

pencil, ink, ink-transfer, and digital print on paper

12 × 12" (30.5 × 30.5 cm)

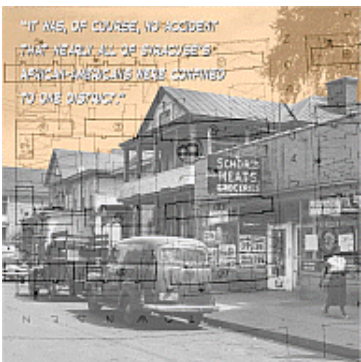

Sekou Cooke

Small Drawings 7, 2020

pencil, ink, ink-transfer, and digital print on paper

12 × 12" (30.5 × 30.5 cm)

Reconstructions: Blackness and Architecture in America

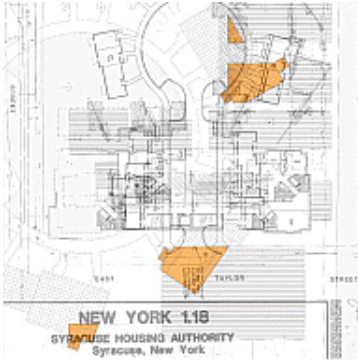

Sekou Cooke

Small Drawings 8, 2020

pencil, ink, ink-transfer, and digital print on paper

12 × 12" (30.5 × 30.5 cm)



Sekou Cooke

Small Drawings 9, 2020

pencil, ink, ink-transfer, and digital print on paper

12 × 12" (30.5 × 30.5 cm)



Sekou Cooke

Syracuse Wall Drawing, 2020

Digital File



Sekou Cooke

Stoop and Model, 2020

Precast concrete, wood, acrylic, and PLA

90" x 30" x 44"

Reconstructions: Blackness and Architecture in America



Germane Barnes
Black Miami Map, 2020
Digital File

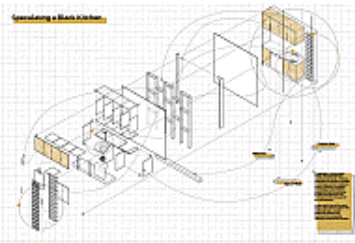

Germane Barnes
Black Kitchen Drawing, 2020
Digital File



Germane Barnes
Spice Rack, 2020
Plastic, Spices, Wood, Acrylic, Drywall, Paper, Adhesive, Metal and Wire
36 × 96 × 132" (91.4 × 243.8 × 335.3 cm)



Germane Barnes
Collages 1, 2020
Digital Collage printed on Vellum and Photo Satin Paper
15" x 21.5"

Reconstructions: Blackness and Architecture in America



Germane Barnes

Collages 2, 2020

Digital Collage printed on Vellum and Photo Satin Paper

15" x 21.25"



Germane Barnes

Collages 3, 2020

Digital Collage printed on Vellum and Photo Satin Paper

15" x 21.25"



Germane Barnes

Collages 4, 2020

Digital Collage printed on Vellum and Photo Satin Paper

18 x 24" (45.7 x 61 cm)



Germane Barnes

Collages 5, 2020

Digital Collage printed on Vellum and Photo Satin Paper

18 x 24" (45.7 x 61 cm)

Reconstructions: Blackness and Architecture in America



Germane Barnes

Collages 6, 2020

Digital Collage printed on Vellum and Photo Satin Paper
15"x21.25"



Germane Barnes

Collages 7, 2020

Digital Collage printed on Vellum and Photo Satin Paper
15" x 21.25"



Germane Barnes

Collages 8, 2020

Digital Collage printed on Vellum and Photo Satin Paper
15" x 21.25"



Germane Barnes

Collages 9, 2020

Digital Collage printed on Vellum and Photo Satin Paper
15" x 21.25"

Reconstructions: Blackness and Architecture in America



Germane Barnes

Collages 10, 2020

Digital Collage printed on Vellum and Photo Satin Paper

15" x 21.25"



Germane Barnes

Collages 11, 2020

Digital Collage printed on Vellum and Photo Satin Paper

15 x 21.25"



Germane Barnes

Collages 12, 2020

Digital Collage printed on Vellum and Photo Satin Paper

15 x 21.25"



Emanuel Admassu

Horizontal Disk (Atlanta), 2020

Glass, Black Sand, Metal, & Fiberglass

80" x 80"

Reconstructions: Blackness and Architecture in America



Emanuel Admassu
Waffle House 1, 2020
Digital file



Emanuel Admassu
Waffle House 2, 2020
Digital file

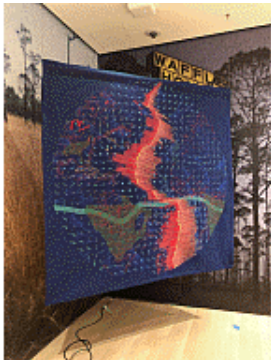

Emanuel Admassu
Vertical Tapestry (Mid-Atlantic Ridge), 2020
Jacquard tapestry, silk, wool and other threads.
7' x 7'



Walter Hood
Wall Drawing, 2020
Digital File

Reconstructions: Blackness and Architecture in America



Walter Hood

Mono prints (color) 1, 2020
Paper, Gouache, Ink, Watercolor
29.5 x 41.5"



Walter Hood

Mono prints (color) 2, 2020
Paper, Gouache, Ink, Watercolor
29.5 x 41.5"



Walter Hood

Mono prints (color) 3, 2020
Paper, Gouache, Ink, Watercolor
29.5 x 41.5"



Walter Hood

Mono prints (color) 4, 2020
Paper, Gouache, Ink, Watercolor
29.5 x 41.5"

Reconstructions: Blackness and Architecture in America



Walter Hood

Mono prints (color) 5, 2020
Paper, Gouache, Ink, Watercolor
29.5 x 41.5"



Walter Hood

Mono prints (color) 6, 2020
Paper, Gouache, Ink, Watercolor
29.5 x 41.5"



Walter Hood

Mono prints (color) 7, 2020
Paper, Gouache, Ink, Watercolor
29.5 x 41.5"



Walter Hood

Mono prints (color) 8, 2020
Paper, Gouache, Ink, Watercolor
29.5 x 41.5"

Reconstructions: Blackness and Architecture in America



Walter Hood

Mono prints (color) 9, 2020
Paper, Gouache, Ink, Watercolor
29.5 x 41.5"



Walter Hood

Mono prints (color) 10, 2020
Paper, Gouache, Ink, Watercolor
29.5 x 41.5"



Walter Hood

Video file with audio (3 min approx), 2020
AV File



Walter Hood

Model 1 (Dirigible), 2020
High density foam, redwood, paint
72" x 39.43 x 24"

Reconstructions: Blackness and Architecture in America



Walter Hood
Model 2 (Exhauster), 2020
High density foam, redwood, paint
72" x 36" x 24"



Walter Hood
Model 3 (Folding Chair), 2020
High density foam, redwood, paint
72 x 24 x 24"



Walter Hood
Models 4 (Furnace), 2020
High density foam, redwood, paint
76.5 x 28 x 18"



Walter Hood
Models 5 (Gear Shift), 2020
High density foam, redwood, paint
72 x 36.8 x 24"

Reconstructions: Blackness and Architecture in America

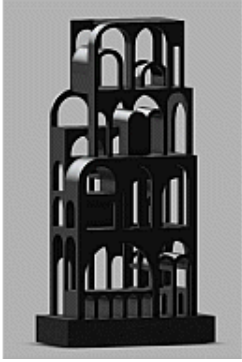

Walter Hood

Model 6 (Mailbox), 2020
High density foam, redwood, paint
72 x 36 x 18"



Walter Hood

Model 7 (Scoop), 2020
High density foam, redwood, paint
72 x 26 x 18"

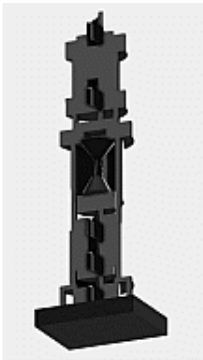

Walter Hood

Model 8 (Sharpener), 2020
High density foam, redwood, paint
72 x 24 x 18"



Walter Hood

Model 9 (Shucker), 2020
High density foam, redwood, paint
72 x 46.6 x 18.85"

Reconstructions: Blackness and Architecture in America

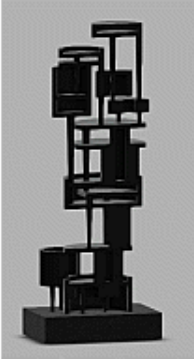

Walter Hood

Model 10 (Sprinkler), 2020
High density foam, redwood, paint
72 x 28 x 18"



Walter Hood

Tower Section 1 (Heater), 2020
Plexiglass
58 x 24"



Walter Hood

Tower Section 2 (Folding Chair), 2020
Plexiglass
58 x 24"



Walter Hood

Tower Section 3 (Mailbox), 2020
Plexiglass
58 x 24"

Reconstructions: Blackness and Architecture in America

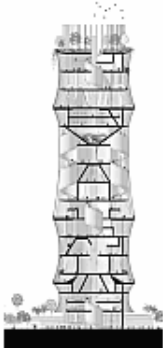

Walter Hood

Tower Section 4 (Sharpener), 2020

Plexiglass

58 x 24"

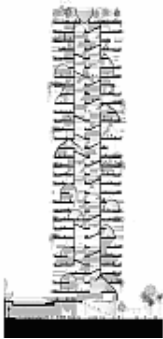

Walter Hood

Tower Section 5 (Furnace), 2020

Plexiglass

58 x 24"



Walter Hood

Tower Section 6 (Dirigible), 2020

Plexiglass

58 x 24"



Olalekan Jeyifous

Subway Kiosk, 2020

Metal and found objects

64 x 32.5" x 18"

Reconstructions: Blackness and Architecture in America



Olaekan Jeyifous

Models 1, 2020

3D Printed

16 × 16 × 16" (40.6 × 40.6 × 40.6 cm)



Olaekan Jeyifous

Models 2, 2020

3D Printed

16 × 16 × 16" (40.6 × 40.6 × 40.6 cm)



Olaekan Jeyifous

Models 3, 2020

3D Printed

16 × 16 × 16" (40.6 × 40.6 × 40.6 cm)



Olaekan Jeyifous

Photomontage 1 - "Grand and Flushing: Farm + Freshwater Corridor", 2020
mounted renderings printed on Luster 260 GSM

72 x 48"

Reconstructions: Blackness and Architecture in America



Olaekan Jeyifous

Photomontage 2 - "The CrownPro Wetland Intersection", 2020
mounted renderings printed on Luster 260 GSM
40 x 30"



Olaekan Jeyifous

Photomontage 3 - "The East New York Greater Gateway", 2020
mounted renderings printed on Luster 260 GSM
40 x 30"



Olaekan Jeyifous

Photomontage 4 - "Plant Seeds, Grow Blessings: BKLYN Interfaith Seed Vault", 2020
mounted renderings printed on Luster 260 GSM
40 x 30"



Olaekan Jeyifous

Photomontage 5 - "Franklin Avenue Shuttle: Gateway Triple-Stack", 2020
mounted renderings printed on Luster 260 GSM
40 x 30"

Reconstructions: Blackness and Architecture in America



Olaekan Jeyifous

Photomontage 6 - "East New York Substation: TFN Clerisy Code-Room IX", 2020

mounted renderings printed on Luster 260 GSM

30 × 40" (76.2 × 101.6 cm)



Olaekan Jeyifous

Photomontage 7 - "TFN - MTA: A/C/E DOCK 4, Gateway Line", 2020

Mounted renderings printed on Luster 260 GSM

30 x 40"



Olaekan Jeyifous

Photomontage 8 - "TFN Deli AD Window", 2020

Mounted rendering printed on Luster 260 GSM

48 × 72"

Olaekan Jeyifous

Video file 1 (for kiosk), 2020

AV File

Reconstructions: Blackness and Architecture in America



Olalekan Jeyifous

Video file 2 (for projectors), 2020
AV File

Olalekan Jeyifous

TFN Daily News LED Display (for kiosk), 2020
AV File



V. Mitch McEwen

Fog Photographs 1, 2020
Digital prints on matt paper
39 3/8 x 29 1/2" (100 x 75 cm)



V. Mitch McEwen

Fog Photographs 2, 2020
Digital prints on matt paper
64 x 85 5/16"

Reconstructions: Blackness and Architecture in America



V. Mitch McEwen
Fog Photographs 3, 2020
Digital prints on matt paper
32 5/8 x 43 7/16" (82.8 x 110.4 cm)



V. Mitch McEwen
Site Model, 2020
3D print PLA and glitter



V. Mitch McEwen
Scale Material Model, 2020
Bamboo, concrete cloth, insulation, felt, Polyurethane rubbers, acetate
127 15/16 x 59 x 3 15/16"



V. Mitch McEwen
Animations, 2020
AV file

Reconstructions: Blackness and Architecture in America



V. Mitch McEwen
Area Plan, 2020
Linen canvas