

Architecture Now: New York, New Publics

The Museum of Modern Art, New York, February 19, 2023 - July 29, 2023

Adjaye Associates



1199SEIU UNITED HEALTHCARE WORKERS EAST
Anton Refregier mural at the former 1199 headquarters in Manhattan
2018–2020
Digital image (for project label)
Photo: 1199SEIU
LN2022.1467



ADJAYE ASSOCIATES
DAVID ADJAYE OBE (Ghanaian-British, born Tanzania, born 1966)
1199SEIU United Healthcare Workers East, Public Member Spaces
2018–2020
Digital photograph (for C-print, with cleat)
© Dror Baldinger, FAIA
LN2022.1464



ADJAYE ASSOCIATES
DAVID ADJAYE OBE (Ghanaian-British, born Tanzania, born 1966)
MARTIN LUTHER KING, JR.
1199SEIU United Healthcare Workers East, Public Member Spaces
2018–2020
Digital audio (on headphones)
LN2022.1465



ADJAYE ASSOCIATES
DAVID ADJAYE OBE (Ghanaian-British, born Tanzania, born 1966)
1199SEIU United Healthcare Workers East, Public Member Spaces
2018–2020
Printed ceramic tiles for wall installation
LN2022.1466



ADJAYE ASSOCIATES
DAVID ADJAYE OBE (Ghanaian-British, born Tanzania, born 1966)
1199SEIU United Healthcare Workers East, Public Member Spaces
2018–2020
Printed magazine to be framed in wall-mounted angled case
17 × 11" (43.2 × 27.9 cm)
LN2022.1468



ADJAYE ASSOCIATES

DAVID ADJAYE OBE (Ghanaian-British, born Tanzania, born 1966)
1199SEIU United Healthcare Workers East, Public Member Spaces
2018–2020

Digital drawing (for inkjet print, with cleat)
LN2022.1469



ADJAYE ASSOCIATES

DAVID ADJAYE OBE (Ghanaian-British, born Tanzania, born 1966)
1199SEIU United Healthcare Workers East, Public Member Spaces
2018–2020

Digital drawing (for inkjet print, with cleat)
LN2022.1470



ADJAYE ASSOCIATES

DAVID ADJAYE OBE (Ghanaian-British, born Tanzania, born 1966)
1199SEIU United Healthcare Workers East, Public Member Spaces
2018–2020

Printed magazine to be framed in wall-mounted angled case
17 × 11" (43.2 × 27.9 cm)
LN2022.1533



ADJAYE ASSOCIATES

DAVID ADJAYE OBE (Ghanaian-British, born Tanzania, born 1966)
1199SEIU United Healthcare Workers East, Public Member Spaces
2018–2020

Digital photograph (for C-print, with cleat)
© Dror Baldinger, FAIA
LN2022.1534

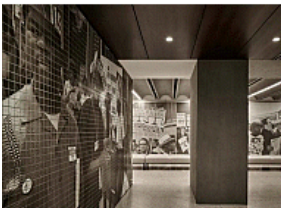

ADJAYE ASSOCIATES

DAVID ADJAYE OBE (Ghanaian-British, born Tanzania, born 1966)
1199SEIU United Healthcare Workers East, Public Member Spaces
2018–2020

Digital photograph (for C-print, with cleat)
© Dror Baldinger, FAIA
LN2022.1536



HUDSON LINES (American, born 1979)

Adjaye Associates, "1199 SEIU United Healthcare Workers East"

2022

Digital, 16:9 video (for LED display)

LN2022.1477

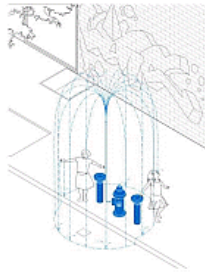

TEI CARPENTER (American, born 1982)
CHRISTOPHER WOEBKEN (American born Germany, 1980)
New Public Hydrant
2018
Digital animations (slideshow for 24" angled monitor on platform)
LN2022.1502



TEI CARPENTER (American, born 1982)
CHRISTOPHER WOEBKEN (American born Germany, 1980)
New Public Hydrant. Hydrants for All.
2022
Metal prototype
46 1/2 × 27 × 7" (118.1 × 68.6 × 17.8 cm)
LN2022.1499

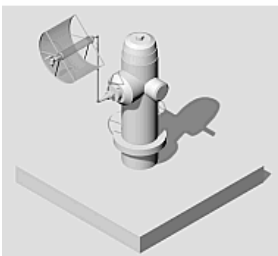

TEI CARPENTER (American, born 1982)
CHRISTOPHER WOEBKEN (American born Germany, 1980)
New Public Hydrant. Solar Tea Station.
2022
Metal prototype
22 11/16 × 18 3/8 × 7 1/2" (57.6 × 46.7 × 19.1 cm)
LN2022.1500



TEI CARPENTER (American, born 1982)
CHRISTOPHER WOEBKEN (American born Germany, 1980)
New Public Hydrant. Hydrant on tap.
2022
Metal prototype
44 3/4 × 6 3/8 × 5 7/8" (113.7 × 16.2 × 14.9 cm)
LN2022.1501

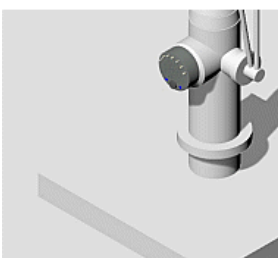

TEI CARPENTER (American, born 1982)
CHRISTOPHER WOEBKEN (American born Germany, 1980)
New Public Hydrant. Sprinkler Boombox.
2022
Metal prototype
6 × 6 × 2 5/8" (15.2 × 15.2 × 6.7 cm)
LN2022.1537



TEI CARPENTER (American, born 1982)
CHRISTOPHER WOEBKEN (American born Germany, 1980)
New Public Hydrant
2022
Digital photograph (for image label)
LN2023.205



HUDSON LINES (American, born 1979)
Agency—Agency and Chris Woebken Studio, "New Public Hydrant"
2022
Digital, 16:9 video (for LED display)
LN2022.1478



Log Train, Thompson Lumber Co.

Digital photograph (for project label)

P90S:32, Photograph Collection, East Texas Research Center, Stephen F. Austin State University.

LN2022.1521

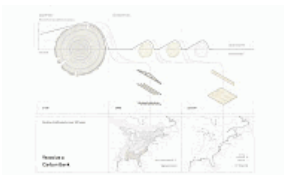

CO ADAPTIVE

BOBBY JOHNSTON

RUTH MANDL (Austrian, born 1983)

Timber Adaptive Reuse Theater

Digital drawing (for inkjet print, with cleat)

LN2022.1472

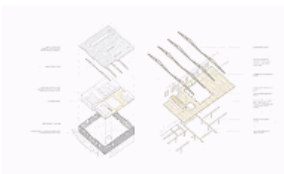

CO ADAPTIVE

BOBBY JOHNSTON

RUTH MANDL (Austrian, born 1983)

Timber Adaptive Reuse Theater

Digital drawing (for inkjet print, with cleat)

LN2022.1473



CO ADAPTIVE

BOBBY JOHNSTON

RUTH MANDL (Austrian, born 1983)

Timber Adaptive Reuse Theater

Digital photograph (for C-Print, with cleat)

Photographer: Naho Kubota

LN2022.1474



CO ADAPTIVE

BOBBY JOHNSTON

RUTH MANDL (Austrian, born 1983)

Timber Adaptive Reuse Theater

Digital photograph (for wallpaper)

Photographer: Naho Kubota

LN2022.1475



CO ADAPTIVE
BOBBY JOHNSTON
RUTH MANDL (Austrian, born 1983)
Timber Adaptive Reuse Theater
Digital photograph (for C-Print, with cleat)
Photographer: Naho Kubota
LN2022.1476



CO ADAPTIVE
BOBBY JOHNSTON
RUTH MANDL (Austrian, born 1983)
Timber Adaptive Reuse Theater
Digital photograph (for wallpaper)
Photographer: Naho Kubota
LN2022.1525



CO ADAPTIVE
Timber Adaptive Reuse Theater
late 19th Century
Wood
3 × 34 × 4" (7.6 × 86.4 × 10.2 cm)
LN2022.1435



CO ADAPTIVE
Timber Adaptive Reuse Theater
late 19th Century
Wood
3 × 38 × 5" (7.6 × 96.5 × 12.7 cm)
LN2022.1541



CO ADAPTIVE
Timber Adaptive Reuse Theater
2022
Wood (Spruce and Pine), cement casting, cork, and museum board
37 1/4 × 19 × 14 1/2" (94.6 × 48.3 × 36.8 cm)
LN2022.1433

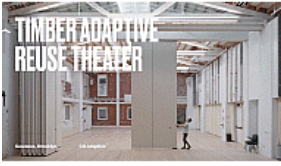

HUDSON LINES (American, born 1979)
CO Adaptive, "Timber Adaptive Reuse Theatre"
2022
Digital, 16:9 video (for LED display)
LN2022.1479



MICHAEL FALCO
View of the Fresh Kills landfill, with the World Trade Center in the background, before its closure in 2001
Digital photograph (for project label)
Courtesy Michael Falco
LN2023.220



JAMES CORNER, FIELD OPERATIONS, NEW YORK (founded 1999)
Freshkills. North Park Arch Model
2022
Model (medium TBD) (mounted on inkjet printed panel on a flat surface)
6 ft, 30" (182.9 × 76.2 cm)
LN2022.1444



JAMES CORNER, FIELD OPERATIONS, NEW YORK (founded 1999)
JAMES CORNER
Freshkills Park. Chapter 4. North Park plan
2022
Digital drawing (for inkjet print, mounted on flat surface)
42 × 18" (106.7 × 45.7 cm)
James Corner Field Operations, courtesy of the City of New York,
Department of Parks
LN2022.1448



JAMES CORNER, FIELD OPERATIONS, NEW YORK (founded 1999)
JAMES CORNER
Freshkills Park. Chapter 1
2022
Digital photograph (for inkjet print, mounted on flat surface)
James Corner Field Operations, courtesy of the City of New York,
Department of Parks
LN2023.206



JAMES CORNER, FIELD OPERATIONS, NEW YORK (founded 1999)
JAMES CORNER
Freshkills Park. Chapter 1
2022
Digital photograph (for inkjet print, mounted on flat surface)
Photo by Mike Segar
LN2023.207



JAMES CORNER, FIELD OPERATIONS, NEW YORK (founded 1999)
JAMES CORNER
Freshkills Park. Chapter 1
2022
Digital photograph (for inkjet print, mounted on flat surface)
Photo by Sean Sweeney
LN2023.208



JAMES CORNER, FIELD OPERATIONS, NEW YORK (founded 1999)
JAMES CORNER
Freshkills Park. Chapter 2
2022
Digital drawing (for inkjet print, mounted on flat surface)
James Corner Field Operations, courtesy of the City of New York,
Department of Parks
LN2023.209



JAMES CORNER, FIELD OPERATIONS, NEW YORK (founded 1999)
JAMES CORNER
Freshkills Park. Chapter 2
2022
Digital drawing (for inkjet print, mounted on flat surface)
James Corner Field Operations, courtesy of the City of New York,
Department of Parks
LN2023.210



JAMES CORNER, FIELD OPERATIONS, NEW YORK (founded 1999)
JAMES CORNER
Freshkills Park. Chapter 2
2022
Digital drawing (for inkjet print, mounted on flat surface)
James Corner Field Operations, courtesy of the City of New York,
Department of Parks
LN2023.211



JAMES CORNER, FIELD OPERATIONS, NEW YORK (founded 1999)
JAMES CORNER
Freshkills Park. Chapter 3
2022
Digital photograph (for inkjet print, mounted on flat surface)
Photograph by Diane Cook and Len Jenshel.
LN2023.212



JAMES CORNER, FIELD OPERATIONS, NEW YORK (founded 1999)
JAMES CORNER
Freshkills Park. Chapter 3
2022
Digital photograph (for inkjet print, mounted on flat surface)
Photograph by Jade Duskow. Courtesy of the Artist and Tracey Morgan Gallery, NC
LN2023.213



JAMES CORNER, FIELD OPERATIONS, NEW YORK (founded 1999)
JAMES CORNER
Freshkills Park. Chapter 3
2022
Digital photograph (for inkjet print, mounted on flat surface)
LN2023.214



JAMES CORNER, FIELD OPERATIONS, NEW YORK (founded 1999)
JAMES CORNER
Freshkills Park. Chapter 3
2022
Digital photograph (for inkjet print, mounted on flat surface)
Photo by Keith Michael @newyorkcitywild
LN2023.215



JAMES CORNER, FIELD OPERATIONS, NEW YORK (founded 1999)
JAMES CORNER
Freshkills Park. Chapter 6
2022
Digital photograph (for inkjet print, mounted on flat surface)
Photo courtesy of Parks Department, City of New York
LN2023.216



JAMES CORNER, FIELD OPERATIONS, NEW YORK (founded 1999)
JAMES CORNER
Freshkills Park. Chapter 6
2022
Digital photograph (for inkjet print, mounted on flat surface)
Photo by Jade Duskow. Courtesy of the Artist and Tracey Morgan Gallery, NC
LN2023.217



JAMES CORNER, FIELD OPERATIONS, NEW YORK (founded 1999)
JAMES CORNER
Freshkills Park. Chapter 6
2022
Digital photograph (for inkjet print, mounted on flat surface)
Photo by Jo Cavallo
LN2023.218



JAMES CORNER, FIELD OPERATIONS, NEW YORK (founded 1999)
JAMES CORNER
Freshkills Park. Chapter 6
2022
Digital photograph (for inkjet print, mounted on flat surface)
Photo by Jo Cavallo
LN2023.219



JAMES CORNER, FIELD OPERATIONS, NEW YORK (founded 1999)
JAMES CORNER
Freshkills Park. Chapter 1
2022
Digital photograph (for inkjet print, mounted on flat surface)
Photo by Diane Cook and Len Jenshel
LN2023.221



HUDSON LINES (American, born 1979)
James Corner Field Operations, "Freshkills Park"
2022
Digital, 16:9 video (for LED display)
LN2022.1480



KINFOLK FOUNDATION (founded 2017)
Kinfolk
Wood pedestal
57 × 52" (144.8 × 132.1 cm)
LN2022.1441



KINFOLK FOUNDATION (founded 2017)
Kinfolk
Digital photograph (for project label)
LN2022.1524



KINFOLK FOUNDATION (founded 2017)
Kinfolk
2022
Wood pedestal
24 × 24" (61 × 61 cm)
LN2022.1440



KINFOLK FOUNDATION (founded 2017)
The Monument Project
2022
Wood pedestal (L)
3 × 60 × 40" (7.6 × 152.4 × 101.6 cm)
LN2022.1442



KINFOLK FOUNDATION (founded 2017)
The Monument project
2022
Digital collage (for inkjet print, with cleat)
24 × 36" (61 × 91.4 cm)
LN2022.1443



KINFOLK FOUNDATION (founded 2017)
The Monument Project
2022
Digital collage (for wallpaper)
LN2022.1511



KINFOLK FOUNDATION (founded 2017)
The Monuments project (David Ruggles)
2022
Augmented Reality App installed on iPad Pro
LN2022.1512



KINFOLK FOUNDATION (founded 2017)
The Monuments project (Seneca Village)
2022
Augmented Reality App installed on iPad Pro
LN2022.1513



KINFOLK FOUNDATION (founded 2017)
The Monuments project (The Young Lords)
2022
Augmented Reality App installed on iPad Pro
LN2022.1514



HUDSON LINES (American, born 1979)
Kinfolk Foundation, "Kinfolk / The Monuments Project"
2022
Digital, 16:9 video (for LED display)
LN2022.1481



Jones Beach State Park circa 1937

2018–2020

Digital photograph (for project label)

New York State Archives. Jones Beach photographs, ca. 1937. Series B1836-04

LN2022.1456



HUDSON LINES (American, born 1979)

nArchitects, "Jones Beach Energy & Nature Center"

2022

Digital, 16:9 video (for LED display)

LN2022.1488



NARCHITECTS

MIMI HOANG (American, born Vietnam)

ERIC BUNGE (American Canadian, born Canada)

Jones Beach Energy & Nature Center

2018–2020

Wood, Paper, Plastic

5 × 54 × 30" (12.7 × 137.2 × 76.2 cm)

LN2022.1427

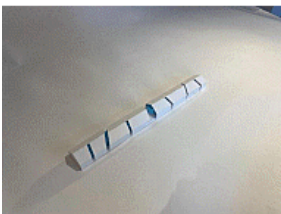

NARCHITECTS

Jones Beach Energy & Nature Center

2018–2020

Paper and tape

1 1/2 × 2 1/4 × 20" (3.8 × 5.7 × 50.8 cm)

LN2022.1428.1



NARCHITECTS

Jones Beach Energy & Nature Center

2018–2020

Paper and tape

1 1/2 × 2 1/4 × 20" (3.8 × 5.7 × 50.8 cm)

LN2022.1428.2



NARCHITECTS

ERIC BUNGE (American Canadian, born Canada)

MIMI HOANG (American, born Vietnam)

Jones Beach Energy & Nature Center

2018–2020

Paper and tape

Component (Sketch Model 01): 1 1/2 × 2 1/4 × 20" (3.8 × 5.7 × 50.8 cm)

LN2022.1428.3



NARCHITECTS

MIMI HOANG (American, born Vietnam)

ERIC BUNGE (American Canadian, born Canada)

Jones Beach Energy and Research Center

2018–2020

Paper and tape

1 1/2 × 3 3/4 × 20" (3.8 × 9.5 × 50.8 cm)

LN2022.1428.4



NARCHITECTS

MIMI HOANG (American, born Vietnam)

ERIC BUNGE (American Canadian, born Canada)

Jones Beach Energy & Nature Center

2018–2020

Paper and tape

1 1/2 × 3 1/4 × 20" (3.8 × 8.3 × 50.8 cm)

LN2022.1428.5



NARCHITECTS

ERIC BUNGE (American Canadian, born Canada)

MIMI HOANG (American, born Vietnam)

Jones Beach Energy & Nature Center

2018–2020

Paper, ink, and colored pencil (framing TBD)

12 × 12 1/2" (30.5 × 31.8 cm)

LN2022.1449

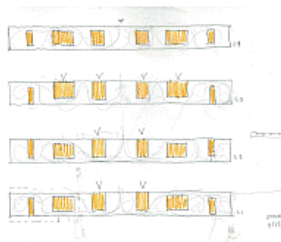

NARCHITECTS

ERIC BUNGE (American Canadian, born Canada)

MIMI HOANG (American, born Vietnam)

Jones Beach Energy & Nature Center

2018–2020

Paper, graphite, and colored pencil (framing TBD)

12 × 16" (30.5 × 40.6 cm)

LN2022.1450



NARCHITECTS

ERIC BUNGE (American Canadian, born Canada)

MIMI HOANG (American, born Vietnam)

Jones Beach Energy & Nature Center

2018–2020

Paper and graphite (framing TBD)

8 1/2 × 11" (21.6 × 27.9 cm)

LN2022.1451



NARCHITECTS

ERIC BUNGE (American Canadian, born Canada)

MIMI HOANG (American, born Vietnam)

Jones Beach Energy & Nature Center

2018–2020

Digital drawing (for inkjet print, with cleat)

20" (50.8 cm)

LN2022.1452



NARCHITECTS

ERIC BUNGE (American Canadian, born Canada)

MIMI HOANG (American, born Vietnam)

Jones Beach Energy & Nature Center

2018–2020

Digital drawing (for inkjet print, with cleat)

LN2022.1454



NARCHITECTS

ERIC BUNGE (American Canadian, born Canada)

MIMI HOANG (American, born Vietnam)

Jones Beach Energy & Nature Center

2018–2020

Digital drawing (for inkjet print, with cleat)

LN2022.1455



NARCHITECTS

ERIC BUNGE (American Canadian, born Canada)

MIMI HOANG (American, born Vietnam)

Jones Beach Energy & Nature Center

2018–2020

Digital photograph (for wallpaper)

Photo: Michael Moran

LN2022.1457

New Affiliates



HUDSON LINES (American, born 1979)
New Affiliates and Samuel Stewart-Halevy, "Testbeds"
2022
Digital, 16:9 video (for LED display)
LN2022.1482



NEW AFFILIATES (founded 2016)
SAMUEL STEWART-HALEVY (American, born 1985)
Testbeds
2019
Digital photograph (for project label)
LN2022.1517



NEW AFFILIATES (founded 2016)
SAMUEL STEWART-HALEVY (American, born 1985)
IVI DIAMANTOPOULOU (Greek, born 1985)
JAFFER KOLB (American, born 1983)
Testbeds
2022
Digital drawing (for inkjet print, to be framed)
40 × 16" (101.6 × 40.6 cm)
LN2022.1458



NEW AFFILIATES (founded 2016)
SAMUEL STEWART-HALEVY (American, born 1985)
IVI DIAMANTOPOULOU (Greek, born 1985)
JAFFER KOLB (American, born 1983)
Testbeds
2022
Digital drawing (for inkjet print, to be framed)
40 × 16" (101.6 × 40.6 cm)
LN2022.1459



NEW AFFILIATES (founded 2016)
SAMUEL STEWART-HALEVY (American, born 1985)
IVI DIAMANTOPOULOU (Greek, born 1985)
JAFFER KOLB (American, born 1983)
Testbeds
2022
Digital drawing (for inkjet print, to be framed)
40 × 16" (101.6 × 40.6 cm)
LN2022.1460



NEW AFFILIATES (founded 2016)
SAMUEL STEWART-HALEVY (American, born 1985)
IVI DIAMANTOPOULOU (Greek, born 1985)
JAFFER KOLB (American, born 1983)
Testbeds
2022
Digital drawing (for inkjet print, to be framed)
40 × 16" (101.6 × 40.6 cm)
LN2022.1461



NEW AFFILIATES (founded 2016)
SAMUEL STEWART-HALEVY (American, born 1985)
IVI DIAMANTOPOULOU (Greek, born 1985)
JAFFER KOLB (American, born 1983)
Testbeds
2022
Digital drawing (for inkjet print, to be framed)
40 × 16" (101.6 × 40.6 cm)
LN2022.1462



NEW AFFILIATES (founded 2016)
SAMUEL STEWART-HALEVY (American, born 1985)
IVI DIAMANTOPOULOU (Greek, born 1985)
JAFFER KOLB (American, born 1983)
Testbeds
2022
Digital drawing (for inkjet print, to be framed)
40 × 16" (101.6 × 40.6 cm)
LN2022.1463



NEW AFFILIATES (founded 2016)
SAMUEL STEWART-HALEVY (American, born 1985)
IVI DIAMANTOPOULOU (Greek, born 1985)
JAFFER KOLB (American, born 1983)
Testbeds
2022
Digital drawing (for inkjet print, to be framed)
40 × 16" (101.6 × 40.6 cm)
LN2022.1489



NEW AFFILIATES (founded 2016)
SAMUEL STEWART-HALEVY (American, born 1985)
IVI DIAMANTOPOULOU (Greek, born 1985)
JAFFER KOLB (American, born 1983)
Testbeds
2022
Digital drawing (for inkjet print, to be framed)
40 × 16" (101.6 × 40.6 cm)
LN2022.1490



NEW AFFILIATES (founded 2016)
SAMUEL STEWART-HALEVY (American, born 1985)
IVI DIAMANTOPOULOU (Greek, born 1985)
JAFFER KOLB (American, born 1983)
Testbeds
2022
Model on circular surface
4 ft diameter (121.9 cm)
LN2022.1526



OLALEKAN JEYIFOUS (American, born Nigeria, 1977)
Made with Love
2018
Digital photograph (for project label)
Photographer: Anthony Artis
LN2022.1518



OLALEKAN JEYIFOUS (American, born Nigeria, 1977)
Made with Love: Fruit Stand
2022
Airbrushed vitreous enamels on optiwhite etched glass (suspended from ceiling)
56 × 90 × 1/4" (142.2 × 228.6 × 0.6 cm)
LN2022.1429



OLALEKAN JEYIFOUS (American, born Nigeria, 1977)
Made with Love: Subway Sandwich
2022
Acrylic 3D print with electrostatic glaze
Component: 8 × 16 × 16" (20.3 × 40.6 × 40.6 cm)
LN2022.1430



OLALEKAN JEYIFOUS (American, born Nigeria, 1977)
Made With Love: Dumplings
2022
Digital drawing (for inkjet print, to be framed)
Plate: 12 × 20" (30.5 × 50.8 cm)
LN2022.1431.1



OLALEKAN JEYIFOUS (American, born Nigeria, 1977)
Made With Love: Quinceañera
2022
Digital drawing (for inkjet print, to be framed)
Plate: 12 × 20" (30.5 × 50.8 cm)
LN2022.1431.2



OLALEKAN JEYIFOUS (American, born Nigeria, 1977)
Made With Love: Ice
2022
Digital drawing (for inkjet print, to be framed)
Plate: 12 × 20" (30.5 × 50.8 cm)
LN2022.1431.3



OLALEKAN JEYIFOUS (American, born Nigeria, 1977)
Made With Love: Bread Display
2022
Digital drawing (for inkjet print, to be framed)
12 × 20" (30.5 × 50.8 cm)
LN2022.1431.4



OLALEKAN JEYIFOUS (American, born Nigeria, 1977)
Made With Love: Borscht
2022
Digital drawing (for inkjet print, to be framed)
Plate: 12 × 20" (30.5 × 50.8 cm)
LN2022.1431.5



OLALEKAN JEYIFOUS (American, born Nigeria, 1977)
Made With Love: Subway Sandwich
2022
Digital drawing (for inkjet print, to be framed)
Plate: 12 × 20" (30.5 × 50.8 cm)
LN2022.1431.6



OLALEKAN JEYIFOUS (American, born Nigeria, 1977)
Made With Love: Kebab
2022
Digital drawing (for inkjet print, to be framed)
Plate: 12 × 20" (30.5 × 50.8 cm)
LN2022.1431.7



OLALEKAN JEYIFOUS (American, born Nigeria, 1977)
Made With Love: Tacos
2022
Digital drawing (for inkjet print, to be framed)
Plate: 12 × 20" (30.5 × 50.8 cm)
LN2022.1431.8



OLALEKAN JEYIFOUS (American, born Nigeria, 1977)
Made With Love: Churros
2022
Digital drawing (for inkjet print, to be framed)
Plate: 12 × 20" (30.5 × 50.8 cm)
LN2022.1431.9



OLALEKAN JEYIFOUS (American, born Nigeria, 1977)
Made With Love: Pizza
2022
Digital drawing (for inkjet print, to be framed)
Plate: 12 × 20" (30.5 × 50.8 cm)
LN2022.1431.10



OLALEKAN JEYIFOUS (American, born Nigeria, 1977)
Made With Love: Bagel
2022
Digital drawing (for inkjet print, to be framed)
Plate: 12 × 20" (30.5 × 50.8 cm)
LN2022.1431.11

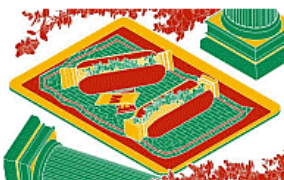

OLALEKAN JEYIFOUS (American, born Nigeria, 1977)
Made With Love: Hot Dogs
2022
Digital drawing (for inkjet print, to be framed)
Plate: 12 × 20" (30.5 × 50.8 cm)
LN2022.1431.12



OLALEKAN JEYIFOUS (American, born Nigeria, 1977)
Made With Love: Noodles
2022
Digital drawing (for inkjet print, to be framed)
Plate: 12 × 20" (30.5 × 50.8 cm)
LN2022.1431.13



OLALEKAN JEYIFOUS (American, born Nigeria, 1977)
Made with Love: Lasagna
2022
Digital drawing (for inkjet print, to be framed)
Plate: 4 × 7" (10.2 × 17.8 cm)
LN2022.1431.14



HUDSON LINES (American, born 1979)
Olalekan Jeyifous, "Made with Love"
2022
Digital, 16:9 video (for LED display)
LN2022.1483



HUDSON LINES (American, born 1979)
Only If Architecture, "The People's Pool"
2022
Digital, 16:9 video (for wall projection)
LN2022.1484



DANNY LYON (American, born 1942)
Kosciosko Swimming Pool, 1974
Digital Image (for project label)
Photo: Danny Lyon Courtesy The U.S. National Archives
LN2023.222



ONLY IF (founded 2013)
Pools Catalogue
2018–2022
Video (for small display)
LN2022.1494



ONLY IF (founded 2013)
KAROLINA MARIA CZĘCZEK (Polish, born 1986)
ADAM SNOW FRAMPTON (American, born 1980)
The People's Pool
2018–2022
Digital drawing (for inkjet print, with cleat)
2 ft × 3 ft (61 × 91.4 cm)
LN2022.1495

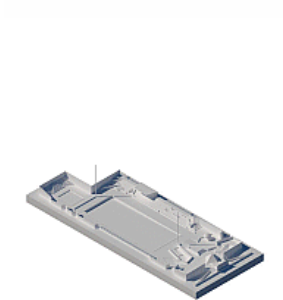

ONLY IF (founded 2013)
The People's Pool
2022
Cast concrete and aluminum
76 1/2 × 31" (194.3 × 78.7 cm)
LN2022.1434



ONLY IF (founded 2013)
The People's Pool
2022
Digital photograph (for C-Print, to be framed)
Image: 16 × 20" (40.6 × 50.8 cm)
Photograph by Anna Morgowicz
LN2022.1496



ONLY IF (founded 2013)
The People's Pool
2022
Digital photograph (for C-Print, to be framed)
Image: 16 × 20" (40.6 × 50.8 cm)
Photograph by Anna Morgowicz
LN2022.1497

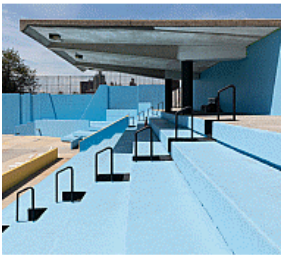

ONLY IF (founded 2013)
The People's Pool
2022
Digital photograph (for C-Print, to be framed)
Image: 16 × 20" (40.6 × 50.8 cm)
Photograph by Anna Morgowicz
LN2022.1498



HUDSON LINES (American, born 1979)
Peterson Rich Office, "Scalable Solutions for NYCHA"
2022
Digital, 16:9 video (for wall projection)
LN2022.1485



PETERSON RICH OFFICE (founded 2012)
Scalable Solutions for NYCHA
2022
Wood, plaster, paint, plastic, and museum board
42 × 24 × 15" (106.7 × 61 × 38.1 cm)
LN2022.1439



PETERSON RICH OFFICE (founded 2012)
NATHAN RICH (American, born 1980)
MIRIAM PETERSON (American, born 1982)
Scalable Solutions for NYCHA
2022
Digital drawing (for inkjet print, with cleat)
18 × 18" (45.7 × 45.7 cm)
LN2022.1505



PETERSON RICH OFFICE (founded 2012)
Scalable Solutions for NYCHA
2022
Digital drawing (for inkjet print, with cleat)
18 × 18" (45.7 × 45.7 cm)
LN2022.1506



PETERSON RICH OFFICE (founded 2012)
Scalable Solutions for NYCHA
2022
Digital drawing (for inkjet print, with cleat)
LN2022.1507



PETERSON RICH OFFICE (founded 2012)
Scalable Solutions for NYCHA
2022
Digital drawing (for inkjet print, with cleat)
LN2022.1508



PETERSON RICH OFFICE (founded 2012)
Scalable Solutions for NYCHA
2022
Digital drawing (for inkjet print, with cleat)
LN2022.1509



PETERSON RICH OFFICE (founded 2012)
Scalable Solutions for NYCHA
2022
Digital drawing (for inkjet print, with cleat)
LN2022.1510



PETERSON RICH OFFICE (founded 2012)
Scalable Solutions for NYCHA
2022
Digital photograph (for project label)
LN2022.1523



HUDSON LINES (American, born 1979)
 SO – IL, "Amant"
 2022
 Digital, 16:9 video (for LED display)
 LN2022.1486



DAVID K ROSS
 SO-IL, Amant, East Williamsburg, US
 2017
 Digital photograph (for project label)
 Photo: David K Ross
 LN2022.1519



SO – IL (FLORIAN IDENBURG + JING LIU) (American, est. 2008)
 FLORIAN IDENBURG (Dutch, born 1975)
 JING LIU (Chinese, born 1980)
 Amant Model
 2017
 Concrete, metal, printed paper, foam
 7 5/8 × 24 1/2 × 51" (19.4 × 62.2 × 129.5 cm)
 LN2022.1432



SO – IL (FLORIAN IDENBURG + JING LIU) (American, est. 2008)
 FLORIAN IDENBURG (Dutch, born 1975)
 JING LIU (Chinese, born 1980)
 IWAN BAAN (Dutch, born 1975)
 Amant
 2021
 Digital photograph (for wallpaper)
 Photo: Iwan Baan
 Landscape Design: Future Green Studio
 LN2022.1491



SO – IL (FLORIAN IDENBURG + JING LIU) (American, est. 2008)
 FLORIAN IDENBURG (Dutch, born 1975)
 JING LIU (Chinese, born 1980)
 IWAN BAAN (Dutch, born 1975)
 Amant
 2021
 Digital photograph (for C-Print, with cleat)
 Image: 11 × 16 1/2" (27.9 × 41.9 cm)
 Photograph by Iwan Baan
 LN2022.1492



SO – IL (FLORIAN IDENBURG + JING LIU) (American, est. 2008)
FLORIAN IDENBURG (Dutch, born 1975)
JING LIU (Chinese, born 1980)
Amant
2017
Digital drawing (for inkjet print, with cleat)
10 × 27" (25.4 × 68.6 cm)
LN2022.1493



SO – IL (FLORIAN IDENBURG + JING LIU) (American, est. 2008)
FLORIAN IDENBURG (Dutch, born 1975)
JING LIU (Chinese, born 1980)
IWAN BAAN (Dutch, born 1975)
Amant
2021
Digital photograph (for C-Print, with cleat)
Image: 11 × 16 1/2" (27.9 × 41.9 cm)
Photo: Iwan Baan
Landscape Design: Future Green Studio
LN2022.1527



SO – IL (FLORIAN IDENBURG + JING LIU) (American, est. 2008)
FLORIAN IDENBURG (Dutch, born 1975)
JING LIU (Chinese, born 1980)
IWAN BAAN (Dutch, born 1975)
Amant
2021
Digital photograph (for C-Print, with cleat)
Image: 11 × 16 1/2" (27.9 × 41.9 cm)
Photo: Iwan Baan
Landscape Design: Future Green Studio
LN2022.1528



SO – IL (FLORIAN IDENBURG + JING LIU) (American, est. 2008)
FLORIAN IDENBURG (Dutch, born 1975)
JING LIU (Chinese, born 1980)
IWAN BAAN (Dutch, born 1975)
Amant
2021
Digital photograph (for C-Print, with cleat)
Image: 11 × 16 1/2" (27.9 × 41.9 cm)
Photo: Iwan Baan
LN2022.1529



SO – IL (FLORIAN IDENBURG + JING LIU) (American, est. 2008)
FLORIAN IDENBURG (Dutch, born 1975)
JING LIU (Chinese, born 1980)
IWAN BAAN (Dutch, born 1975)
Amant
2021
Digital photograph (for C-Print, with cleat)
Image: 11 × 16 1/2" (27.9 × 41.9 cm)
Photo: Iwan Baan
LN2022.1530



SO – IL (FLORIAN IDENBURG + JING LIU) (American, est. 2008)
FLORIAN IDENBURG (Dutch, born 1975)
JING LIU (Chinese, born 1980)
IWAN BAAN (Dutch, born 1975)
Amant
2021
Digital photograph (for C-Print, with cleat)
Image: 11 × 16 1/2" (27.9 × 41.9 cm)
Photo: Iwan Baan
LN2022.1531

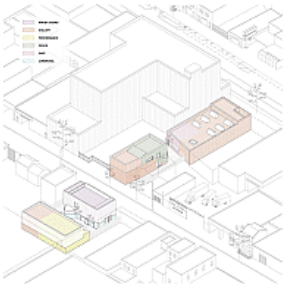

SO – IL (FLORIAN IDENBURG + JING LIU) (American, est. 2008)
FLORIAN IDENBURG (Dutch, born 1975)
JING LIU (Chinese, born 1980)
Amant. Programmatic Axonometric Drawing
2017
Digital drawing (for inkjet print, with cleat)
Image: 18 × 18" (45.7 × 45.7 cm)
LN2022.1532



HUDSON LINES (American, born 1979)
SWA/Balsley and Weiss/Manfredi, "Hunter's Point South Waterfront Park"
2022
Digital, 16:9 video (for LED display)
LN2022.1487

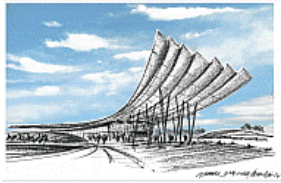

WEISS/MANFREDI ARCHITECTS, NEW YORK, NY
Hunter's Point South Waterfront Park
unknown
Charcoal drawing, digital print on paper (to be framed)
13 1/2 x 24" (34.3 x 61 cm)
©Marion Weiss and Michael Manfredi, courtesy of SWA/Balsley and WEISS/MANFREDI
LN2022.1447

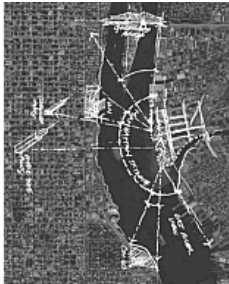

WEISS/MANFREDI ARCHITECTS, NEW YORK, NY
Hunters Point South Waterfront Park
2008
Digital drawing (for project label)
©Marion Weiss and Michael Manfredi, courtesy of SWA/Balsley and WEISS/MANFREDI
LN2022.1520



WEISS/MANFREDI ARCHITECTS, NEW YORK, NY
Hunter's Point South Waterfront Park
2009
Charcoal on digital print, clearprint vellum (to be framed)
11 x 17" (27.9 x 43.2 cm)
©Marion Weiss and Michael Manfredi, courtesy of SWA/Balsley and WEISS/MANFREDI
LN2022.1445



WEISS/MANFREDI ARCHITECTS, NEW YORK, NY
Hunter's Point South Waterfront Park
2009
Charcoal on digital print, clearprint vellum (to be framed)
14 x 17" (35.6 x 43.2 cm)
©Marion Weiss and Michael Manfredi, courtesy of SWA/Balsley and WEISS/MANFREDI
LN2022.1446



WEISS/MANFREDI ARCHITECTS, NEW YORK, NY
SWA/BALSLEY (American, founded 1972)
Hunter's Point South Waterfront Park
2009–2018
Digital photograph (for wallpaper)
©Lloyd/SWA, courtesy of SWA/Balsley and WEISS/MANFREDI
LN2022.1471



WEISS/MANFREDI ARCHITECTS, NEW YORK, NY
Hunter's Point South Waterfront Park,
2017–2018
Acrylic, paper, and cardboard
3 1/2 × 12 3/4 × 30 1/2" (8.9 × 32.4 × 77.5 cm)
WEISS/MANFREDI, courtesy of SWA/Balsley and WEISS/MANFREDI
LN2022.1437



WEISS/MANFREDI ARCHITECTS, NEW YORK, NY
MICHAEL MANFREDI (American)
MARION WEISS (American, born 1957)
Hunter's Point South Waterfront Park
2018
Milled plastic
4 × 16 1/2 × 51 1/4" (10.2 × 41.9 × 130.2 cm)
WEISS/MANFREDI, courtesy of SWA/Balsley and WEISS/MANFREDI
LN2022.1436

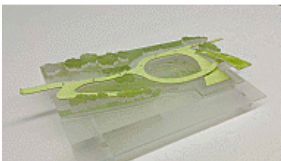

WEISS/MANFREDI ARCHITECTS, NEW YORK, NY
Hunter's Point South Waterfront Park
ca. 2018
Frosted acrylic
2 1/2 × 9 × 10" (6.4 × 22.9 × 25.4 cm)
WEISS/MANFREDI, courtesy of SWA/Balsley and WEISS/MANFREDI
LN2022.1438



New York, New Public's banner at gallery entry
LN2022.1515



New York, New Public's map with project locations
LN2022.1516